



Image for illustrative purpose only

## Summary

<a href="#">Request a quote</a>	
<a href="#">Catalog</a>	
Size	0S
Series	S - Indoor Stepped Insert

# Technical details

## Form & Material

Shell style / Model id	GRA - Insulating washer
Housing material	Polyamide, red
Keying	No keying
Weight	0.07 g

## Environment

Technical domain	Audio Video, Energy and Industrial, Semiconductor, Test and Measurement
Environmental sealing (IP rating)	No IP rating
Temperature range	-40°C / +90°C
Climatical Category	50/175/21
Humidity (max)	<=95% [at 60 deg C /140 F]
Shielding (min)	75 dB (10 MHz)
Shielding (min)	40 dB (1 GHz)
Shock Resistance	100 g [ 6 ms]
Vibration	15 g [10 Hz - 2000 Hz]

## Drawings

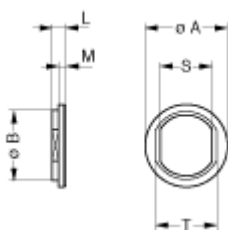

No keying

## Dimensions

	A	B	L	M	S	T
mm.	12	10.8	1.8	1	8.3	9.9
in.	0.47	0.43	0.07	0.04	0.33	0.39

[https://www.lemo.com/int\\_en/solutions/originals/s-indoor-stepped-insert/gra-0s-269-gr.html](https://www.lemo.com/int_en/solutions/originals/s-indoor-stepped-insert/gra-0s-269-gr.html)

LEMO products and services are provided "as is". LEMO makes no warranties or representations with regard to LEMO product & services or use of them, express, implied or statutory, including for accuracy, completeness, or security. The user is fully responsible for his products and applications using LEMO components.