

V2.1

3DMAKERPRO

store.3dmakerpro.com

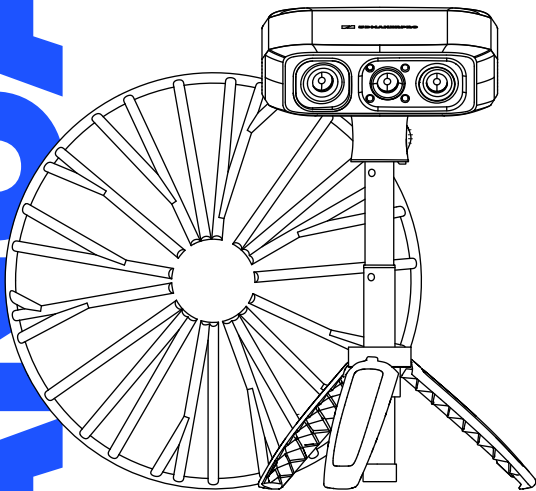

MOOSE & MOOSE Lite

3DMAKERPRO

f @3DMakerProCares

@official3DMakerPro

@3DMakerPro

<https://store.3dmakerpro.com/>

service@3dmakerpro.com

JimuMeta

f @JimuMeta

@JimuMeta

<https://www.jimumeta.com/>

service@jimumeta.com

Download latest **JMStudio** from

<https://forum.jimumeta.com/home/help/download.html>

Get latest **Manual** from

<https://forum.jimumeta.com/home/help/manual.html>



3D MAKERPRO LIMITED

Hardware connection

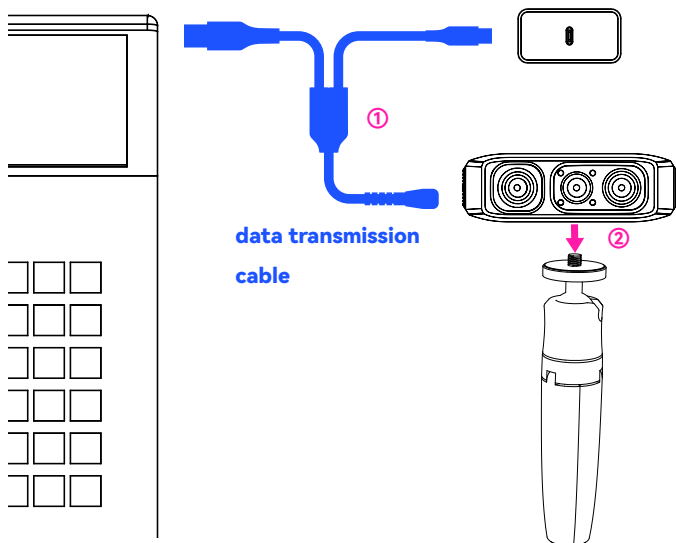

① Plug the longer "L" type plug of the device cable into the scanner, another two shorter ends into the PC USB port and power adapter respectively.

② Connect the tripod to the scanner body by inserting the screw thread on the top into the screw hole in the another and tighten it clockwise.

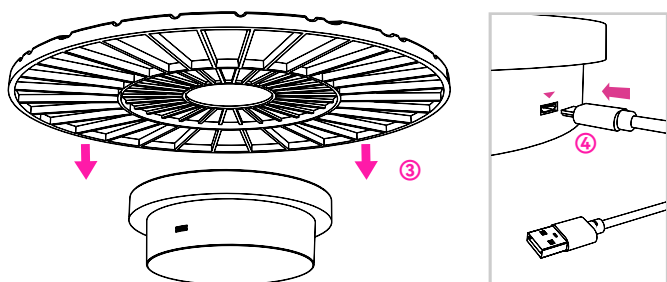

③ Place the Turntable Surface on top of the turntable.

④ Plug the Micro USB end of the turntable cable into the turntable and the USB end to a power source.

Packing list

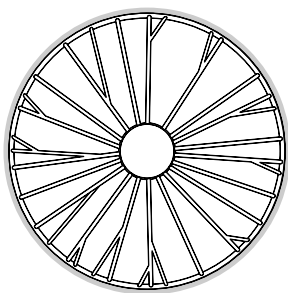

Turntable Surface¹

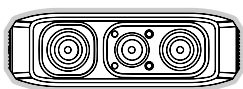

scanner body

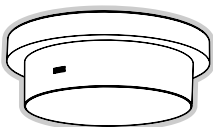

turntable²



power adapter

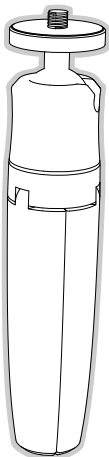

tripod³



turntable cable⁴



data transmission cable

* Product images are for illustrative purposes only.

* ¹²³⁴Not included in the Standard Combo.

Operating System Requirement



Minimum	Intel Core i5 8th, 16GB RAM, MX250 GPU with 2GB VRAM
Recommended	Intel Core i7 8th, 16GB RAM, NVDIA1060 GPU with 4GB VRAM